

OTB-560

c **UL** **us** (FW2)

Pitch (terminal to terminal) : 7.62mm

PAT
Integral Type

lot : 100pcs.

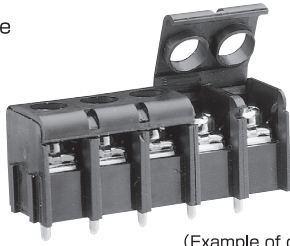

(Example of combination)



(2P)



(3P)

Number of terminals : Number of poles required
[combination of 2P and 3P]

Specifications

Electrical Rating	300V, 12A
Insulation Resistance	DC500V, 1000MΩ
Withstanding Voltage	AC2500V
Storage Temperature Rating	-25°C~+80°C
Usage Temperature Rating	-25°C~+80°C
Terminal Block Color Available	Black

OTB-560-2P

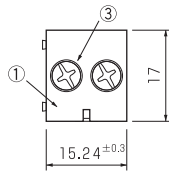

OTB-560-3P

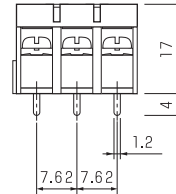
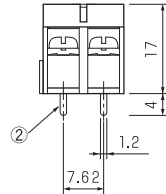
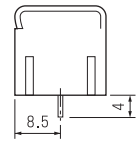
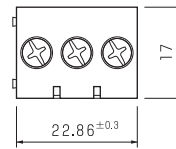

Composition

No.	Part Name	Materials	Flame Class	Treatment	Remarks
①	Base	PA 66	94V-0		With an integrated cover
②	Terminal	Brass		Sn	
③	Screw (M3)	Steel		Ni	F Series